

Poynting

Making wireless happen

www.poynting.tech



DASH-3 User Guide

South Africa

Unit 4, N1 Industrial Park
Landmarks Ave
Samrand, 0157,
South Africa
Tel: +27 12 657 0050
info@poynting.tech

Europe

Kronstadler Straße 4,
81677 München
Germany
Tel: +49 89 2080 265 38
Mob.: +49 176 529 733 50
sales-europe@poynting.tech

Introduction 1

This User Guide provides information on the installation instructions of the DASH-3 antenna

Packing Check List 2

Item	Description	Quantity
1.	A-DASH-0003 Antenna only	1
2.	M8 Slotted brass nut	1

The appearance of each component

Antenna unit

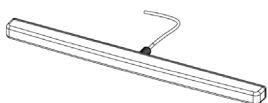

M8 Slotted brass nut

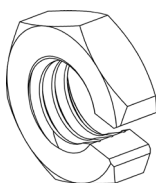

Optional Accessories 3

Optional Accessories

1. Various cable extensions are available

4 Tools Required

Item	
Safety goggles	
Drills (Pilot drill 3mm and 8.5mm)	
Masking tape	
Hand drilling machine	
Centre punch	
Hammer	
27mm spanner/wrench	
Drilling template	(Available on www.poynting.tech)

Mounting the antenna

- Download the 1:1 drill template from <http://www.poynting.tech>.
- Once you have decided on the location use the downloaded 1:1 drill template to mark the mounting location.
- To prevent the marking tool or drill sliding off course, use masking tape over the drilling point to help hold the drill point in place. The masking tape also prevents hot shavings from the drill or hole saw which could penetrate and damage the painted surface.
- Use a drilling machine with drill bit to make the hole to the required size. It is recommended that you use a smaller drill bit for a pilot hole first.

Note: The recommended drill hole diameter for DASH-3 is Ø8.5mm.

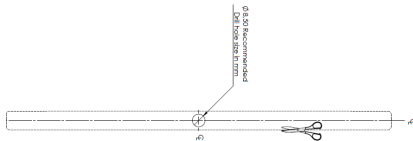

Go to www.poynting.tech to download the scale 1:1 template

- Clean the entire surface on which you plan to mount the antenna. Cleaning is done to ensure good contact of the foam surface to the mounting area. Alcohol wipes can be used to remove oil and dirt from the surface.
- Remove the wax protection paper from the adhesive foam seal at the base of the antenna.
- Insert the antenna cables and threaded spigot through the drilled hole.

- Push the antenna down onto the mounting surface and make sure the antenna is placed straight and correctly.
- Fit the M8 nut from the inside of the mounting platform.
- Tighten the M8 Nut to 2.5Nm torque. Be careful not to over tighten the nut.

Installation Drawing

Note: Torque specifications:

Recommended fastening torque 2.5Nm
max tightening torque is 3Nm

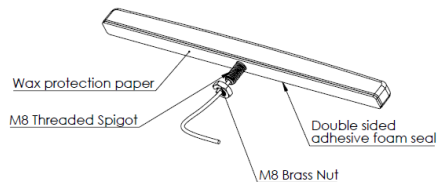
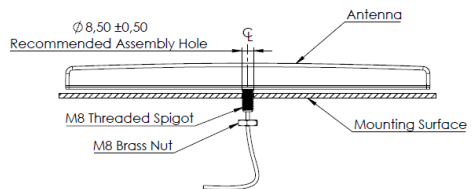

- Survey the planned cable route and look for any blocked passages. Consider alternate routes to find the best available path. If extension cables are needed, refer to the cable configuration diagram. Always keep the cables as short as possible to make sure that minimum cable losses are achieved.
- Avoid running cables through components or sharp apertures that may cause excessive chafing. Doing so may erode the jacket and break signal continuity. Also, avoid kinking, pinching, or twisting a cable during a run.
- Use cable ties to secure the antenna cables.

When handling the antenna cables, it is essential you follow these basic rules:

- Never pull on the cable connectors; pull only on the cable.

- Use safety goggles when drilling the antenna hole.
- Avoid using bits that are dull, bent or damaged.
- Be aware of where your fingers are in relation to the drill bit when using the drilling machine.
- To stop the drilling machine, let the drill chuck come to a complete stop on its own.
- Never grasp the chuck in an attempt to stop the drill bit.
- Avoid operating while under the influence of drugs, alcohol or medication.
- Make sure that any loose fitting jewellery or clothing is secured and tie back long hair as they can get caught in moving parts during installation.
- Avoid awkward hand positions where a sudden slip could cause a hand to move into the drill bit or cutting tool.